

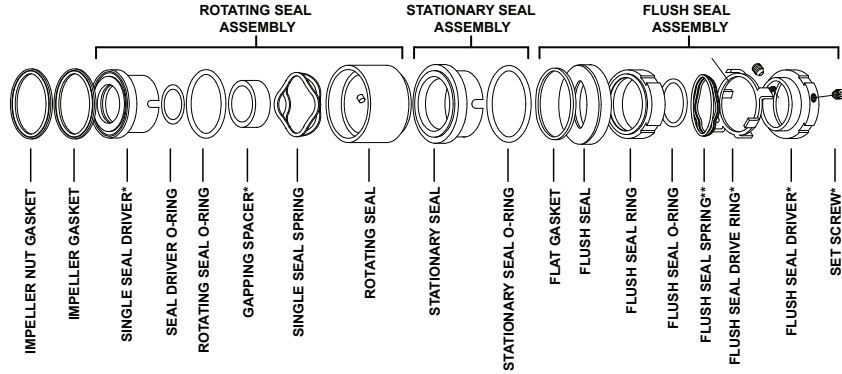

FPH/FPHP/FM3 Double Seal Assembly Sizes: HP1, HP3

P.O. Box 620065, MIDDLETON, WI 53562
TEL: (800)841-5001 FAX: (608)831-8467
www.fristam.com / fristam@fristampumps.com

DWG # 1265000669 REV -
CARD PART # 1050000265



*NOT SUPPLIED IN WEAR PARTS KIT

**FLUSH SEAL SPRING HAS A WHITE STRIPE ON THE OUTSIDE EDGE (EXCEPT MODEL 722);
ROTATING SEAL SPRING DOES NOT

DWG # 1265000668

When replacing ANY seal part, it is important to replace ALL seal wear parts.



FM5 Double Seal Assembly Sizes: HP4

P.O. Box 620065, MIDDLETON, WI 53562
TEL: (800)841-5001 FAX: (608)831-8467
www.fristam.com / fristam@fristampumps.com

DWG # 1265000670 REV -
CARD PART # 1050000266

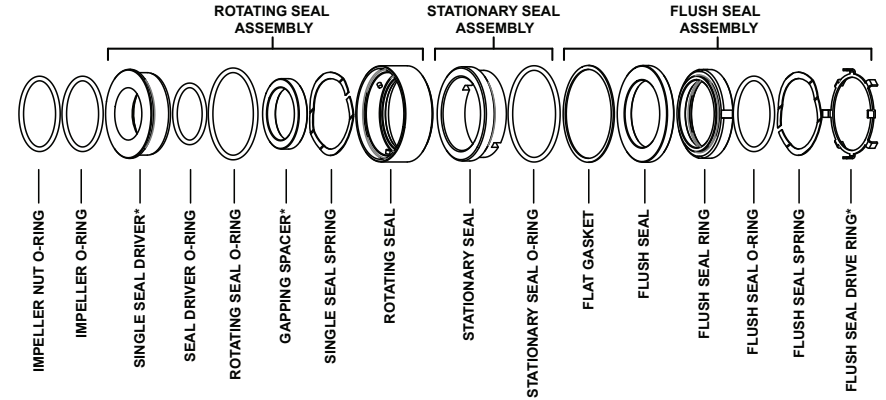

*NOT SUPPLIED IN WEAR PARTS KIT

DWG # 1265000667

When replacing ANY seal part, it is important to replace ALL seal wear parts.