



FP/FPX Double Seal Assembly

Sizes: 633, 735, 736

P.O. Box 620065, MIDDLETON, WI 53562
 TEL: (800)841-5001 FAX: (608)831-8467
 www.fristam.com / fristam@fristampumps.com

DWG # 1265000400 REV A
 CARD PART # 1050000215

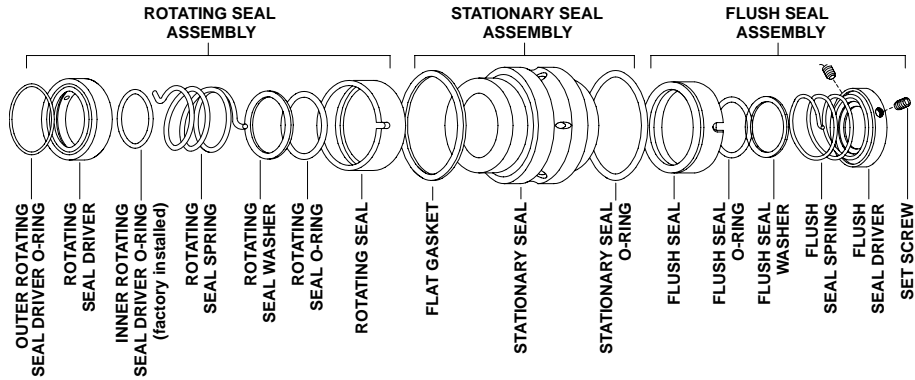

DWG # 1265000544 REV -



FP/FPX Single Seal Assembly

Sizes: 633, 735, 736

P.O. Box 620065, MIDDLETON, WI 53562
 TEL: (800)841-5001 FAX: (608)831-8467
 www.fristam.com / fristam@fristampumps.com

DWG # 1265000401 REV A
 CARD PART # 1050000156

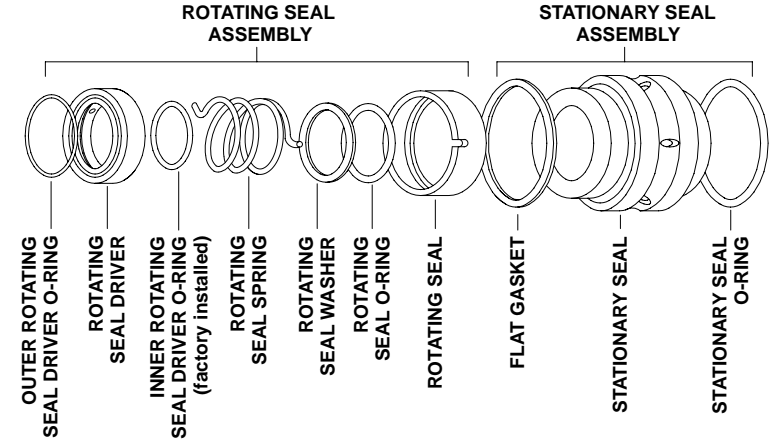

DWG # 1265000542 REV -



FP/FPX Double Seal Assembly

Sizes: 633, 735, 736

Split-Center Seal

P.O. Box 620065, MIDDLETON, WI 53562
 TEL: (800)841-5001 FAX: (608)831-8467
 www.fristam.com / fristam@fristampumps.com

DWG # 1265000566 REV -
 CARD PART # 1050000250

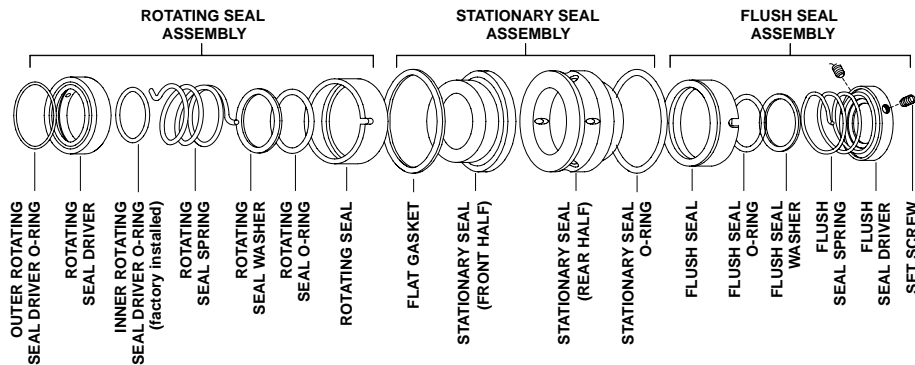

DWG # 1265000557 REV -



FP/FPX Single Seal Assembly

Sizes: 633, 735, 736

Split-Center Seal

P.O. Box 620065, MIDDLETON, WI 53562
 TEL: (800)841-5001 FAX: (608)831-8467
 www.fristam.com / fristam@fristampumps.com

DWG # 1265000567 REV -
 CARD PART # 1050000249

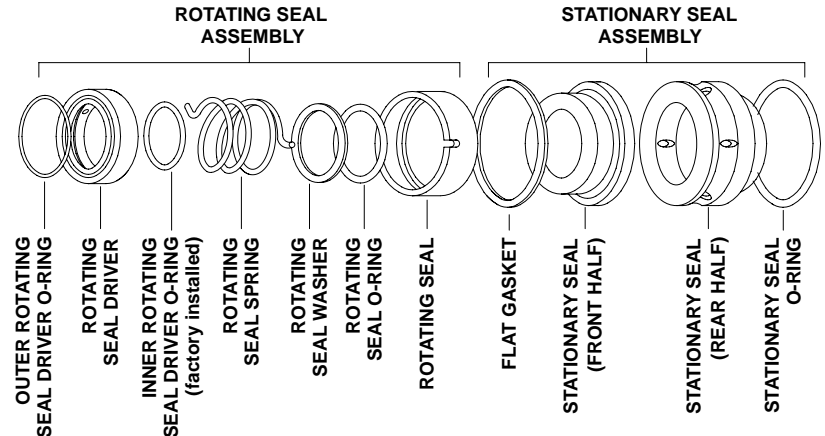

DWG # 1265000556 REV -



FP/FPX/FZX* Single Seal Assembly
Sizes: 633, 735, 736 (*FZX, pre-2001)
External Seal Seal

P.O. Box 620065, MIDDLETON, WI 53562
 TEL: (800)841-5001 FAX: (608)831-8467
 www.fristam.com / fristam@fristampumps.com

DWG # 1265000577 REV -
 CARD PART # 1050000255

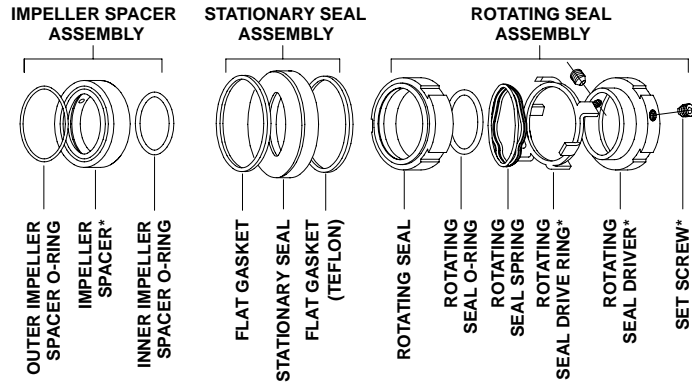

* ONLY INCLUDED IN THE FOLLOWING NON-WEAR PARTS KITS:
 1802300006 (633), 1802300007 (735), 1802300008 (736)

DWG # 1265000576 REV -