

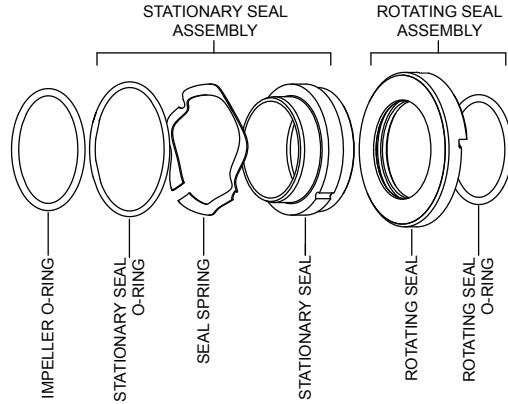

## FZX 2000 Single Seal Assembly Size: 57

P.O. Box 620065, MIDDLETON, WI 53562  
TEL: (800)841-5001 FAX: (608)831-8467  
www.fristam.com / fristam@fristampumps.com

DWG # 1265000552 REV -  
CARD PART # 1050000251



DWG # 1265000553 REV B

When replacing ANY seal part, it is important to replace ALL seal wear parts.



## FZX 2000 Double Seal Assembly Size: 57

P.O. Box 620065, MIDDLETON, WI 53562  
TEL: (800)841-5001 FAX: (608)831-8467  
www.fristam.com / fristam@fristampumps.com

DWG # 1265000554 REV -  
CARD PART # 1050000252

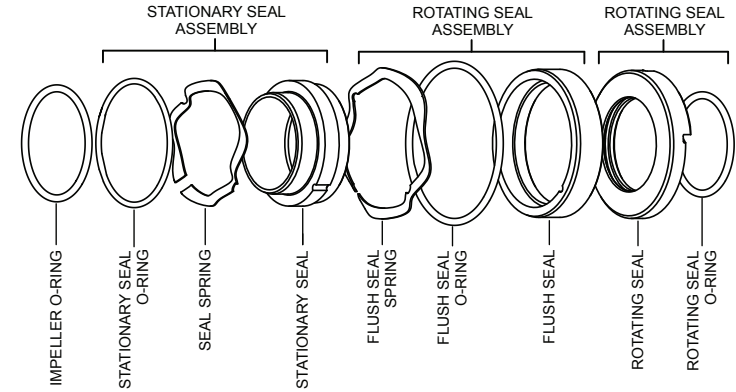

DWG # 1265000555 REV -

When replacing ANY seal part, it is important to replace ALL seal wear parts.



## FZX 2000 Single Seal Assembly Size: 86

P.O. Box 620065, MIDDLETON, WI 53562  
TEL: (800)841-5001 FAX: (608)831-8467  
www.fristam.com / fristam@fristampumps.com

DWG # 1265000671  
CARD PART # 1050000268

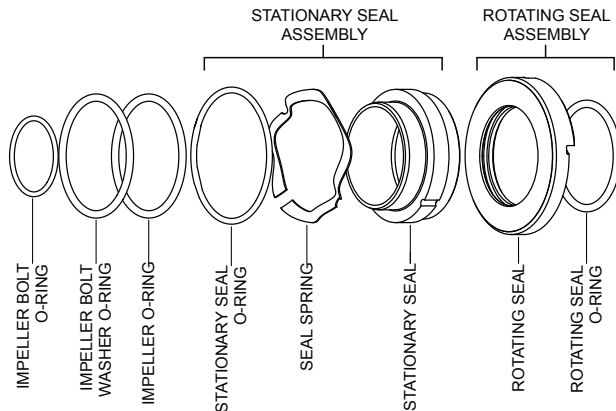

DWG # 1265000666

When replacing ANY seal part, it is important to replace ALL seal wear parts.



## FZX 2000 Double Seal Assembly Size: 86

P.O. Box 620065, MIDDLETON, WI 53562  
TEL: (800)841-5001 FAX: (608)831-8467  
www.fristam.com / fristam@fristampumps.com

DWG # 1265000671  
CARD PART # 1050000269

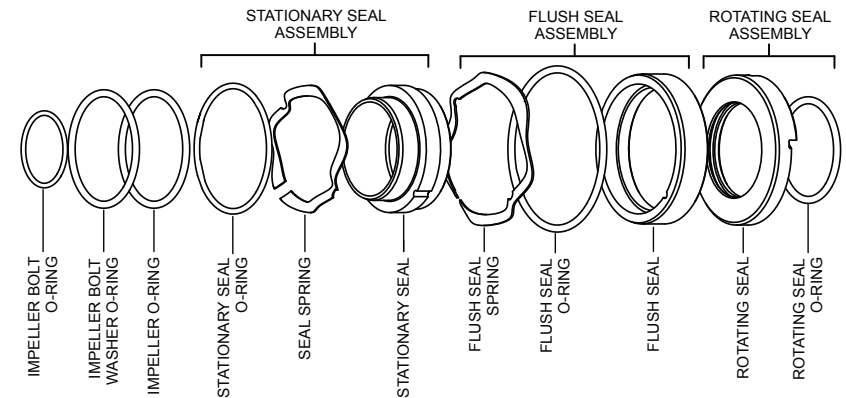

DWG # 1265000673 REV -

When replacing ANY seal part, it is important to replace ALL seal wear parts.



**FZX (pre-2001) Double Seal Assembly**  
**Size: 735**  
**External Seal**

P.O. Box 620065, MIDDLETON, WI 53562  
 TEL: (800)841-5001 FAX: (608)831-8467  
 www.fristam.com / fristam@fristampumps.com

DWG # 1265000579 REV -  
 CARD PART # 1050000256

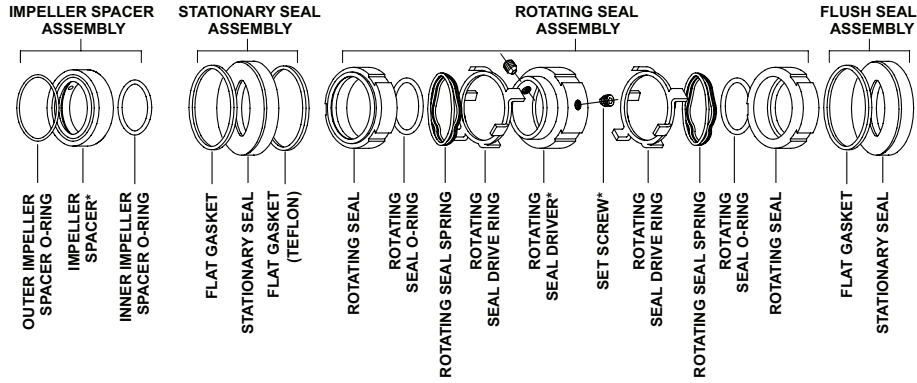

\* NOT SUPPLIED IN WEAR PARTS KIT

DWG # 1265000578 REV -



**FZX (pre-2001) Single Seal Assembly**  
**Sizes: 633, 735, 736**  
**External Seal**

P.O. Box 620065, MIDDLETON, WI 53562  
 TEL: (800)841-5001 FAX: (608)831-8467  
 www.fristam.com / fristam@fristampumps.com

DWG # 1265000577 REV -  
 CARD PART # 1050000255

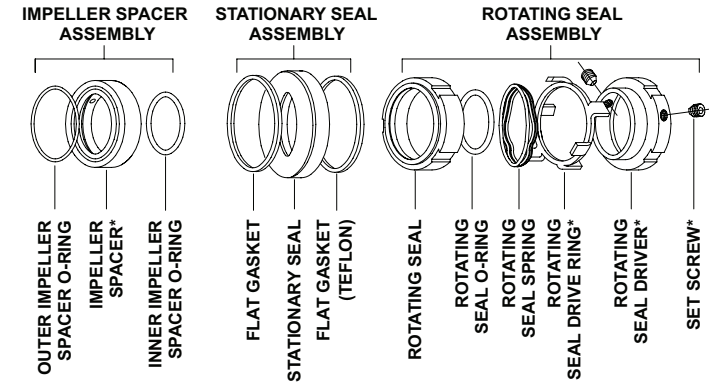

\* ONLY INCLUDED IN THE FOLLOWING NON-WEAR PARTS KITS:

1802300006 (633), 1802300007 (735), 1802300008 (736)

DWG # 1265000576 REV -